

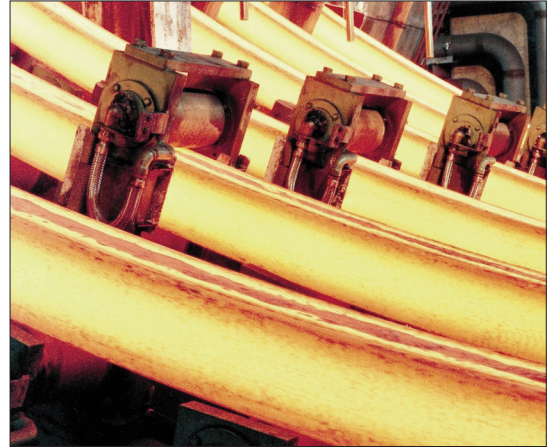

Lechler GmbH
 Precision Nozzles • Nozzle Systems
 P.O. Box 13 23
 72544 Metzingen / Germany
 Phone: +49 (0) 71 23 962-0
 Fax: +49 (0) 71 23 962-333
 E-Mail: info@lechler.de
 Internet: www.lechler.de

Full Cone Nozzles 486 series 3/8" female thread



Full cone nozzles with R 3/8" female thread. Circular uniform full cone spray pattern. Very common in secondary cooling systems of billet and bloom casters designed and built by Concast.

Standard material brass, stainless steel as well as other spray angles and flow rates available on request

spray angle	Type	Mat.-No.		Thread code	Code	flow rate V [l/min]
		30	1C			pressure p [bar]
45°	486.443	●	●	AF	1545 L	1,50
	486.493	●	●	AF	2045 L	2,00
	486.563	●	●	AF	3045 L	3,00
	486.593	●	●	AF	3545 L	3,50
	486.613	●	●	AF	4045 L	4,00
	486.653	●	●	AF	5045 L	5,00
	486.683	●	●	AF	6045 L	6,00
	486.713	●	●	AF	7045 L	7,00
	486.733	●	●	AF	8045 L	8,00

Example for ordering Type + Material no. + Thread Code = Ordering no.
 486.444 + 1C + AF = 486.444.1C.AF

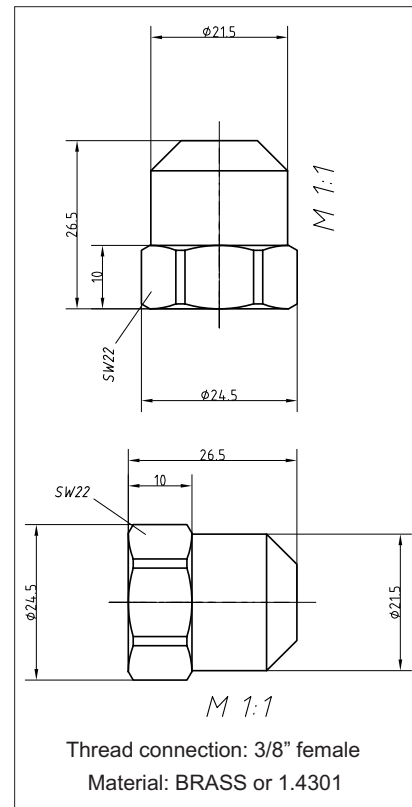

LEADING SPRAY TECHNOLOGISTS



NOZZLES



LANCES



HEADERS



CONTROLS



SYSTEMS



Lechler GmbH
 Precision Nozzles • Nozzle Systems
 P.O. Box 13 23
 72544 Metzingen / Germany
 Phone: +49 (0) 71 23 962-0
 Fax: +49 (0) 71 23 962-333
 E-Mail: info@lechler.de
 Internet: www.lechler.de

Full Cone Nozzles 486 series 3/8" female thread

spray angle	Type	Mat.-No.		Thread code	Code	flow rate V [l/min]
		30	1C			pressure p [bar]
		Brass	1.4301			2,8
65°	486.444	●	●	AF	1565 L	1,50
	486.494	●	●	AF	2065 L	2,00
	486.534	●	●	AF	2565 L	2,50
	486.564	●	●	AF	3065 L	3,00
	486.594	●	●	AF	3565 L	3,50
	486.614	●	●	AF	4065 L	4,00
	486.634	●	●	AF	4565 L	4,50
	486.654	●	●	AF	5065 L	5,00
	486.674	●	●	AF	5565 L	5,50
	486.684	●	●	AF	6065 L	6,00
	486.704	●	●	AF	6565 L	6,50
	486.714	●	●	AF	7065 L	7,00
	486.724	●	●	AF	7565 L	7,50
	486.734	●	●	AF	8065 L	8,00
	486.744	●	●	AF	8565 L	8,50
	486.754	●	●	AF	9065 L	9,00
	486.764	●	●	AF	9565 L	9,50
	486.774	●	●	AF	10065 L	10,00
486.814	●	●	AF	12065 L	12,00	
486.834	●	●	AF	14065 L	14,00	
486.854	●	●	AF	15065 L	15,00	
486.864	●	●	AF	16565 L	16,50	

90°	486.446	●	●	AF	1590 L	1,50
	486.496	●	●	AF	2090 L	2,00
	486.536	●	●	AF	2590 L	2,50
	486.566	●	●	AF	3090 L	3,00
	486.596	●	●	AF	3590 L	3,50
	486.616	●	●	AF	4090 L	4,00
	486.636	●	●	AF	4590 L	4,50
	486.656	●	●	AF	5090 L	5,00
	486.676	●	●	AF	5590 L	5,50
	486.686	●	●	AF	6090 L	6,00
	486.706	●	●	AF	6590 L	6,50
	486.716	●	●	AF	7090 L	7,00
	486.726	●	●	AF	7590 L	7,50
	486.736	●	●	AF	8090 L	8,00
	486.746	●	●	AF	8590 L	8,50
	486.756	●	●	AF	9090 L	9,00
	486.766	●	●	AF	9590 L	9,50
	486.776	●	●	AF	10090 L	10,00
486.816	●	●	AF	12090 L	12,00	

100°	486.597	●	●	AF	36100 L	3,60
------	---------	---	---	----	---------	------

Example for ordering Type + Material no. + Thread Code = Ordering no.
 486.444 + 1C + AF = 486.444.1C.AF

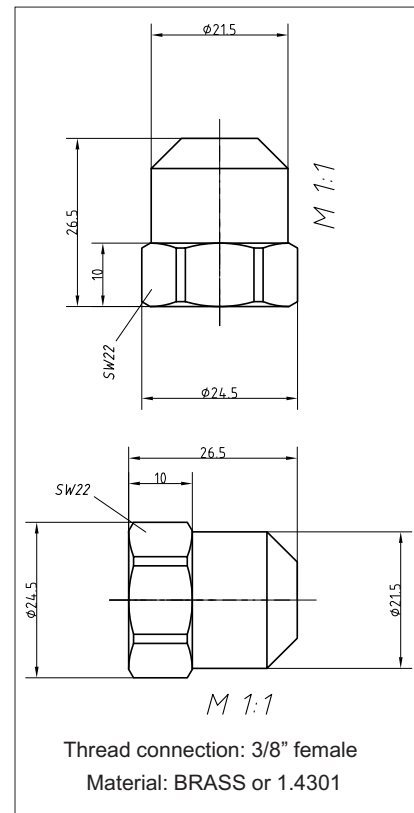

LEADING SPRAY TECHNOLOGISTS



NOZZLES



LANCES



HEADERS



CONTROLS



SYSTEMS